

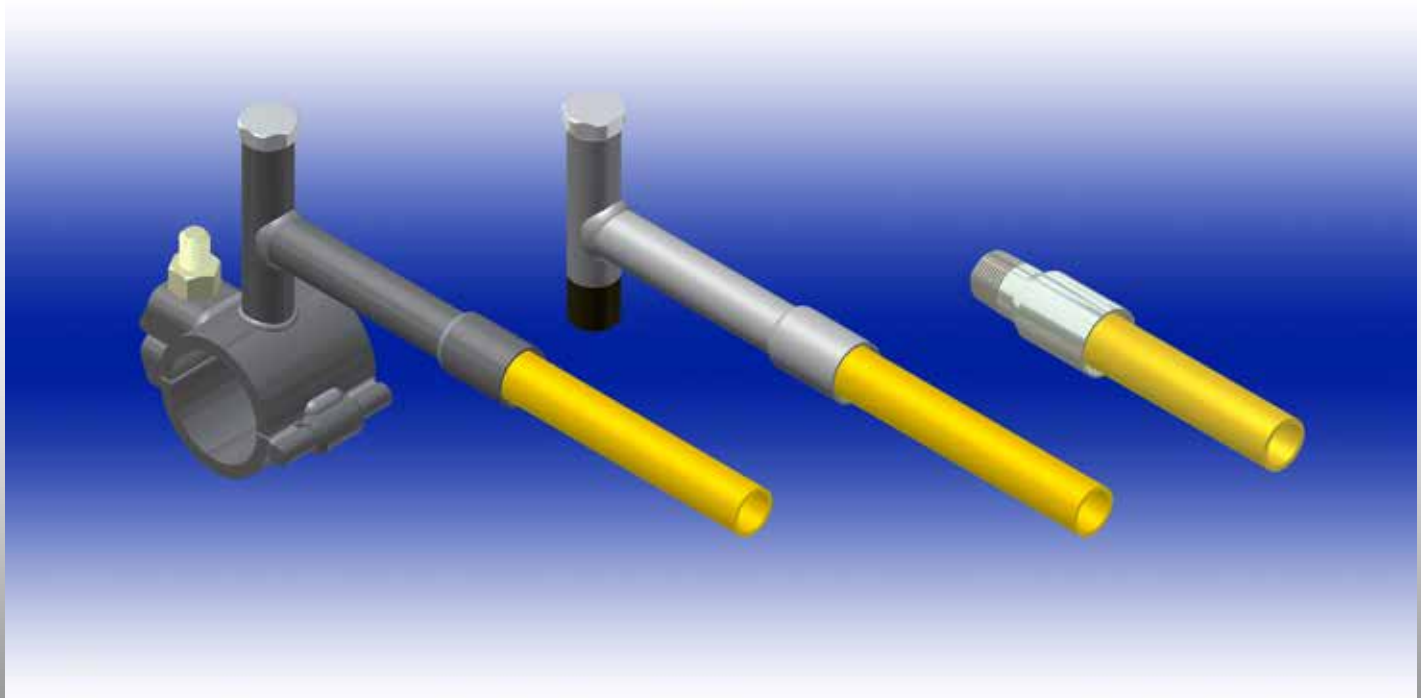

Gas Connectors & Accessories

TRANSITION FITTINGS

TRANSITION FITTINGS



1-800-558-1373 or FAX 1-800-788-1668 • Visit www.conind.com



TRANSITION FITTINGS

Polyethylene Pipe x Pipe Thread or Weld End
For Joining Polyethylene Pipe To Metallic Pipe

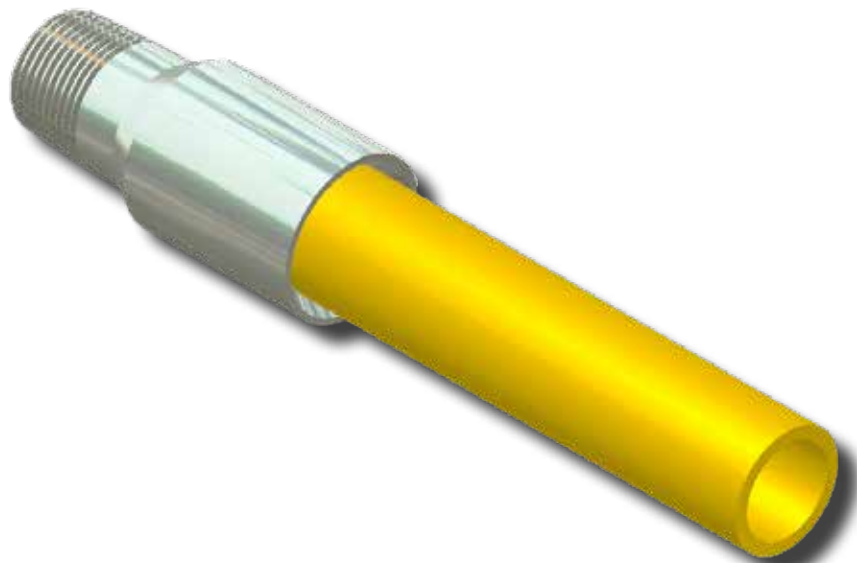
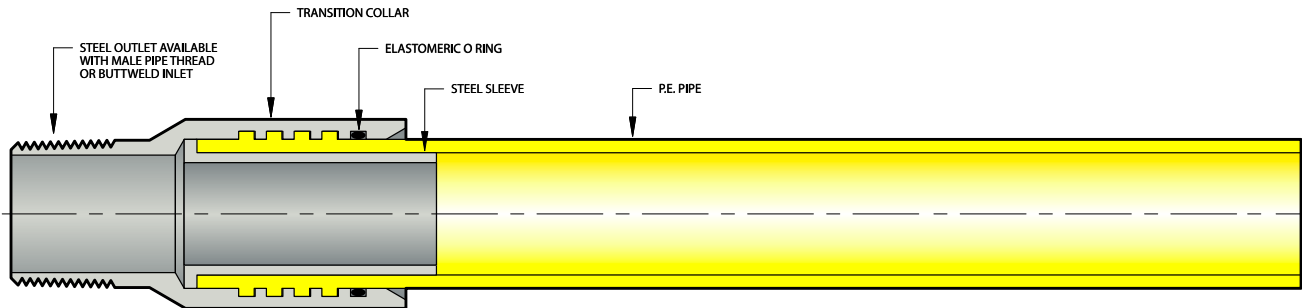

- **O-RING SEAL PROVIDES POSITIVE SEAL**
- **ZINC PLATED FOR CORROSION PROTECTION**
- **MECHANICALLY HELD - PROVIDES MAXIMUM PULL-OUT RESISTANCE—tensile strength exceeds requirements of D.O.T., Title 49 of the Code of Federal Regulations, Part 192.283 (b)**
- **AVAILABLE WITH 2406/2708 OR 3408/4710 P.E. EXTENSIONS**
- **CONFORMS TO ASTM D2513, & ANSI B31.8 & DOT 192.121**
- **AVAILABLE WITH MALE PIPE THREADED END**



TRANSITION FITTINGS

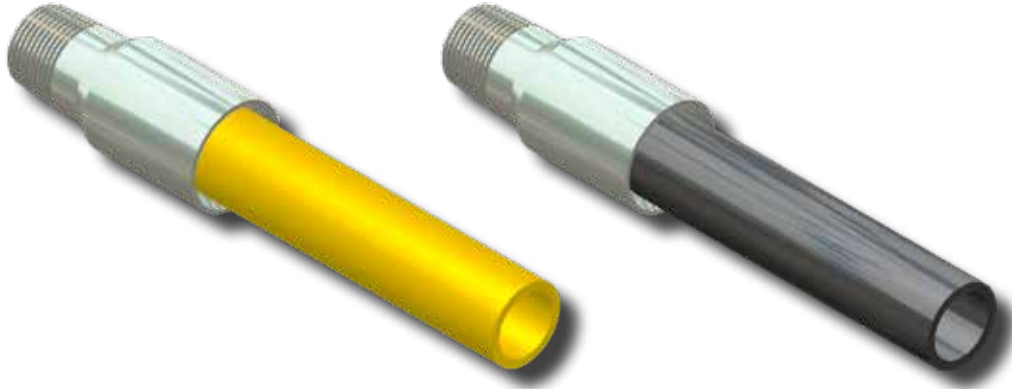

OUTLET	WALL	INLET	PART NUMBER 2406/2708	PART NUMBER 3408/4710	OVERALL LENGTH
1/2" CTS (5/8" OD)	.090	1/2" MPT	4646-00-1904-00†‡	4949-00-1904-00‡	14 3/8"
1" CTS (1 1/8" OD)	.099/.101	1" MPT	4646-00-1908-00†‡	4949-00-1908-00‡	14 3/4"
1/2" IPS	SDR-9.33 (.090)	3/4" MPT	4646-00-1912-00‡	4949-00-1912-00‡	14 11/32"
3/4" IPS	SDR-11 (.095)	3/4" MPT	4646-00-1913-00†‡	4949-00-1913-00‡	15"
1" IPS	SDR-11 (.119)	1" MPT	4646-00-1914-00†‡	4949-00-1914-00‡	16 1/8"
1 1/4" IPS	SDR-10 (.166)	1 1/4" MPT	4646-00-1915-00†‡	Not Available	16 1/16"
1 1/4" IPS	SDR-11 (.151)	1 1/4" MPT	4646-00-1915-0A†‡	4949-00-1915-0A‡	16 1/16"
1 1/2" IPS	SDR-11 (.171)	1 1/2" MPT	4646-00-1916-00†‡	4949-00-1916-00‡	16 5/16"
2" IPS	SDR-11 (.166)	2" MPT	4646-00-1917-00†‡	4949-00-1917-00‡	16 11/16"

For sizes not listed, contact Continental Industries.

Pressure rating—Designed to meet or exceed pressure rating of PE pipe per 49 CFR Part 192 and ASTM D2513.

† = CSA Approved / ‡ = IAPMO/UPC Listed

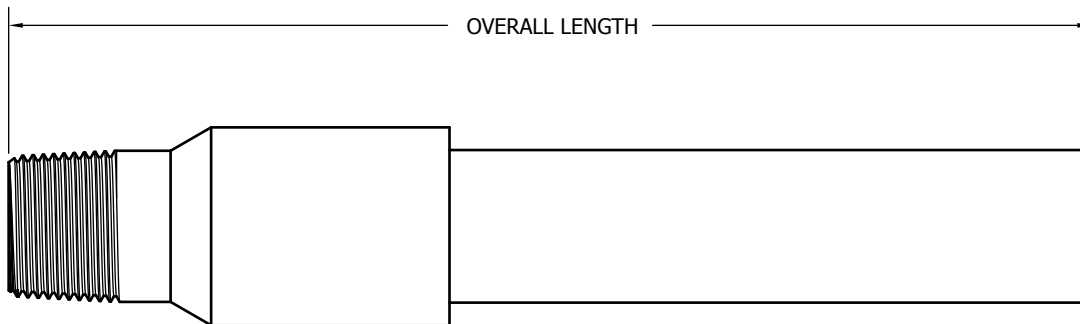

Two Proven Designs - I.D. and O.D. Seal

Lyall is the only manufacturer that offers two distinct transition sealing methods allowing a larger choice of configurations to meet your requirements. Our one-piece, factory assembled transitions provide safe, economical and easy-to-install connections between gas carrying steel pipe and polyethylene (PE) pipe.

Proven Reliability - both designs have been approved by most natural gas, propane and industrial fluid companies with over 4 million in service.

Features

- Meets or exceeds all industry requirements.
- Epoxy or primer coatings available.
- Fusion bonded epoxy coating provides superior resistance to corrosion and mechanical damage.
- All welded joints are 100% pressure tested.
- Meets or exceeds the requirements of ASTM D2513 category 1, ASME B 31.8, US CFR 49 Part 192.
- Listed with IAPMO/UPC and certified to CSA B137.4

